

L-2025-1 Toberleheen, Co. Offaly  
DIVERSION ROUTE

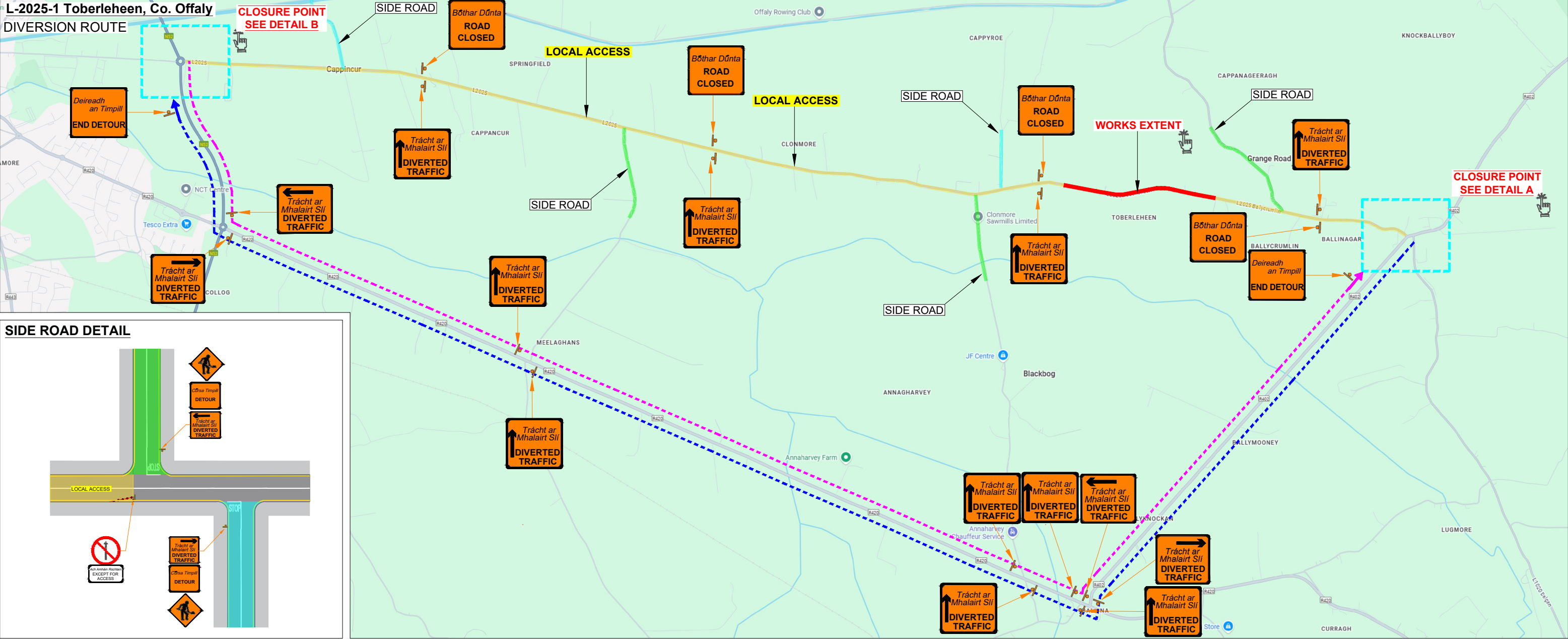

WORKS EXTENT

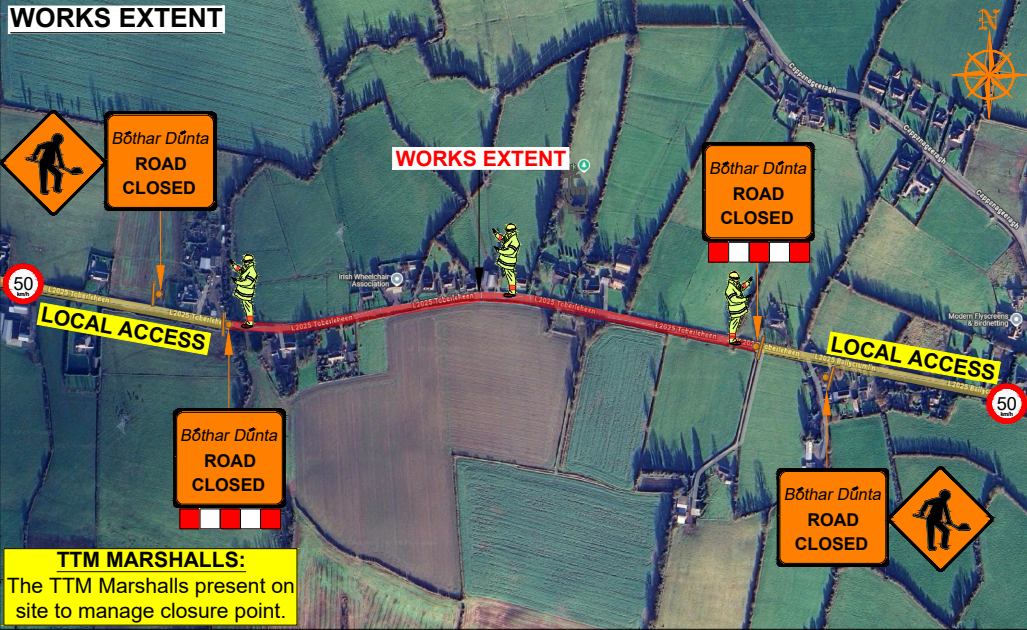

DETAIL A

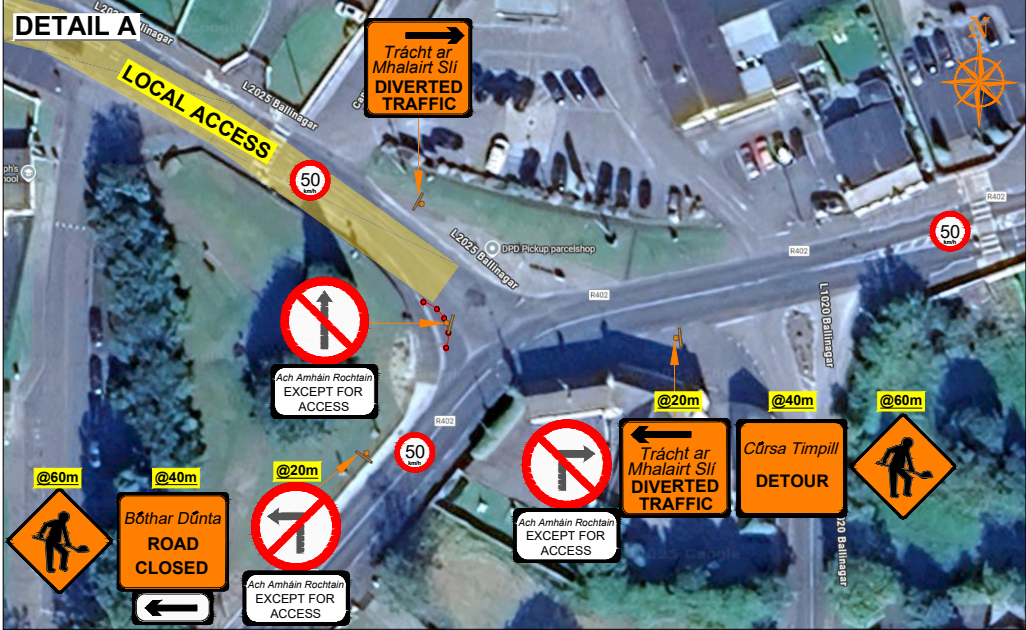

DETAIL B

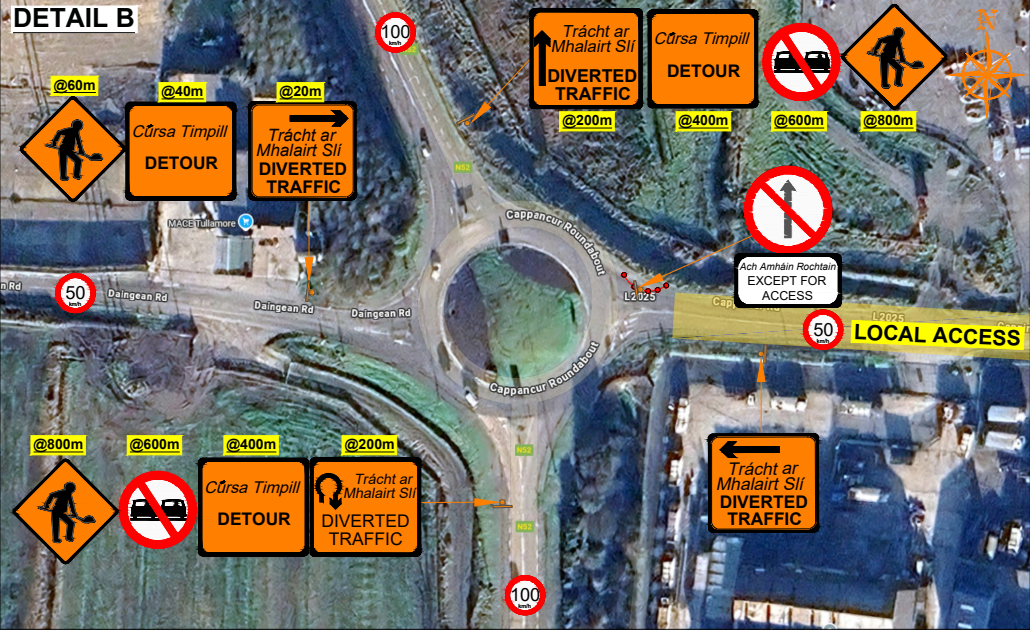

**ROAD CONTROL**

Copyright Notes:  
This drawing is the property of Road Control Services Ltd. The design information contained herein is strictly confidential. This document is not to be used, reproduced, disclosed or circulated in whole or in part without prior written consent.

CLIENT

**Kilsaran**  
ideas taking shape

DESIGN PARAMETERS		Speed Limit	Road Classification
Advance Warning Signage		50	1(iii) >12hours
Sign size	600mm		
Sign Visibility	50m		
Number of Signs	2		
Cumulative Distance	40m		
Distance between Advance Warning Signs	20m		
Taper			
Lane Taper Rate	N/A		
Hard Shoulder Taper Rate	N/A		
Safety Zones			
Longitudinal	5m		
Lateral	0.5m		
Lanes			
Lane Width	3.0m		

LEGEND	
XXXX	Works Area
●	Traffic sign
●	Traffic cones
●	Local Access
----	Diversion Route A
----	Diversion Route B

**GENERAL NOTES**

1) All information contained in this drawing (including digital data) should be checked and verified prior to any stage of construction;  
2) All works are to be carried out in accordance with local authority requirements and are to be included in the site-specific safety & health plan;  
3) Site inspections and maintenance of the traffic management layout is to be agreed with local authority to ensure the safety and integrity of the design;  
4) Contractor to carry out a site risk assessment prior to the installation of any traffic management plan to ensure that conditions reflect those considered for design post submission;  
5) Contractor shall be responsible for the provision of ramp access at any change in road surface level where traffic runs on a temporary surface, and for pedestrian/cycle ramps where footpath/cycle-ways have a level discontinuity as per result of the works.

Rev	Date	Details	Drn	Chk	App	Drn	DJ
						Chk	SD
						App	DH
						Date	23-04-2024
						Scale	NTS @A3
						Stage	CONSTRUCTION

Project		Title	
L-2025-1 Toberleheen, Co. Offaly		TEMPORARY TRAFFIC MANAGEMENT DIVERSION ROUTE	
Drawing No	C25002_10_001	Rev	0