

© greenlight-Im Traffic Management Design & Consultancy



NOTES:

- A) ALL INFORMATION CONTAINED IN THIS TTM DRAWING SHOULD BE CHECKED AGAINST THE EXISTING ROAD GEOMETRY TO ENSURE THAT THIS TRAFFIC MANAGEMENT DRAWING IS AS PER CURRENT CONDITIONS.
- B) THE TEMPORARY TRAFFIC MANAGEMENT CONTRACTOR IS REQUIRED TO HAVE CARRIED OUT A DYNAMIC ON-SITE RISK ASSESSMENT PRIOR TO THE INSTALLATION OF THIS TTM DRAWING TO ENSURE THAT THE CONDITIONS REFLECT THOSE CONSIDERED FOR THE DESIGN.
- C) ALL TTM WORKS ARE TO BE CARRIED OUT IN ACCORDANCE WITH GOVERNING BODY AND LOCAL AUTHORITY REQUIREMENTS AND BE INCLUDED IN THE SAFETY & HEALTH PLAN

SITE SPECIFIC NOTE:

- ROAD CLOSURE & DETOUR OF L3001
- LOCAL ACCESS TO BE MAINTAINED BY USE OF TRAFFIC MASHALLS AT BOTH CLOSURE POINTS
- ADJOINING SIDE ROAD DETAIL TO BE INSTALLED AT MAIN ROAD JUNCTIONS WITHIN THE ADVANCE ROAD CLOSURE POINTS
- TRAFFIC APPROACHING THE ROAD CLOSURE POINTS IS TO BE TURNED TO RETURN THE WAY THEY APPROACHED FROM AND ADVISED TO JOIN THE DETOUR ROUTES
- THE DETOUR ROUTE IS A MINIMUM OF REGIONAL ROAD FOR THE ENTIRE LENGTH

ADJOINING SIDE ROAD DETAIL

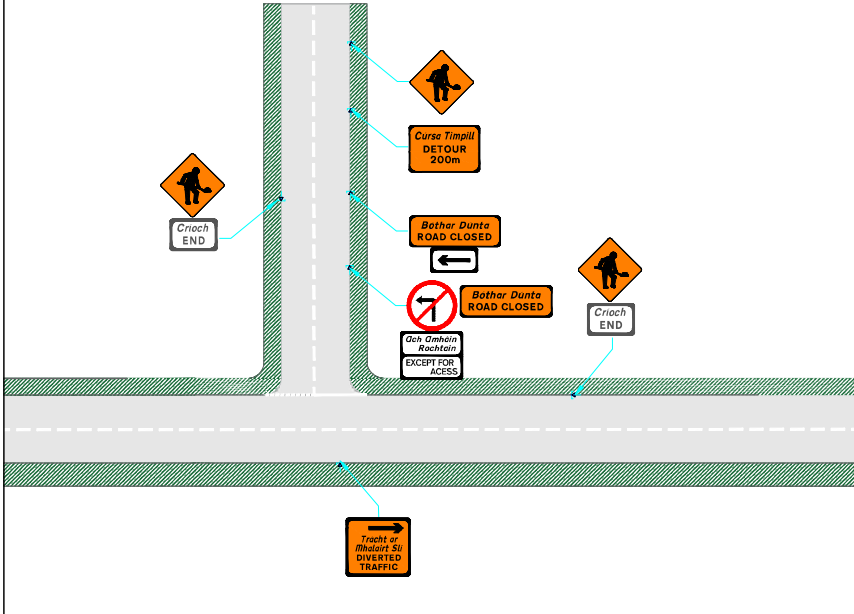

CHAPTER 8 - ROAD LEVEL 2(i) 80km/h

Design Parameters	TYPE A >12 hours	TYPE B <12 hours	TYPE C <15 mins
Advance Warning Signs			
Sign Size (mm)	600	600	-
Sign Visibility (m)	90	90	90
No. of Signs	4	3	-
Cumulative Distance (m)	480	360	-
Distance between Advance Warning Signs (m)	120	120	-
Taper			
Lane Taper Rate	1 in 40	1 in 40	-
Hard Shoulder Taper Rate	1 in 40	1 in 40	-
Cones			
Cone Height (mm)	750	750	-
Taper Spacing (m)	3	3	-
Longitudinal Spacing (m)	12	12	-
Lamps (unit areas only)			
Taper Spacing (m)	6	6	-
Longitudinal Spacing (m)	24	24	-
Safety Zones			
Longitudinal (m)	45	45	-
Lateral (m)	1.2	1.2	-
Lanes (minimum)			
Lane Width (m)	3	3	-

REV:	DESCRIPTION:	BY:	DATE:
KEY:	ROAD CONE		
	SIGN MARKER		
	WORKS AREA		
	LONGITUDINAL SAFETY ZONE		
	LATERAL SAFETY ZONE		

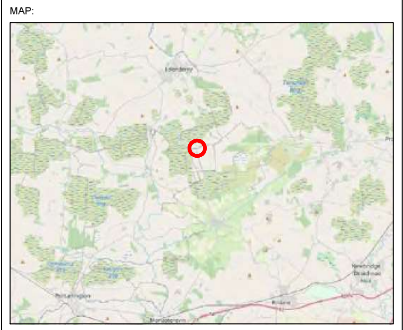

PROJECT:	HIGHWAY MAINTENANCE		
TITLE:	ROAD CLOSURE & DETOUR L3001		
SCALE AT A3:	NTS	DATE:	CHECKED:
		22/03/2023	NW
DRAWING NO:	D007-107-002b		REVISION:
			0