

Design Parameter	Type A > 12 hours	Type B < 12 hours	Type C < 15 mins
Advance Warning Signage			
Sign Size (mm)	600	600	-
Sign Visibility (m)	90	90	90
Number of Signs	4	3	-
Cumulative Distance (m)	480	360	-
Distance between Advance Warning Signs (m)	120	120	-
Taper			
Lane Taper Rate <sup>A</sup>	1 in 40	1 in 40	-
Hard Shoulder Taper Rate <sup>A</sup>			-
Cones			
Cone Height (mm)	750	750	-
Taper Spacing (m) <sup>B</sup>	3	3	-
Longitudinal Spacing (m) <sup>B</sup>	12	12	-
Lamps (unlit areas only)			
Taper Spacing (m)	6	6	-
Longitudinal Spacing (m)	24	24	-
Safety Zones			
Longitudinal (m)	45	45	-
Lateral (m)	1.2	1.2	-
Lanes			
Lane Width (m) <sup>C</sup>	3	3	-

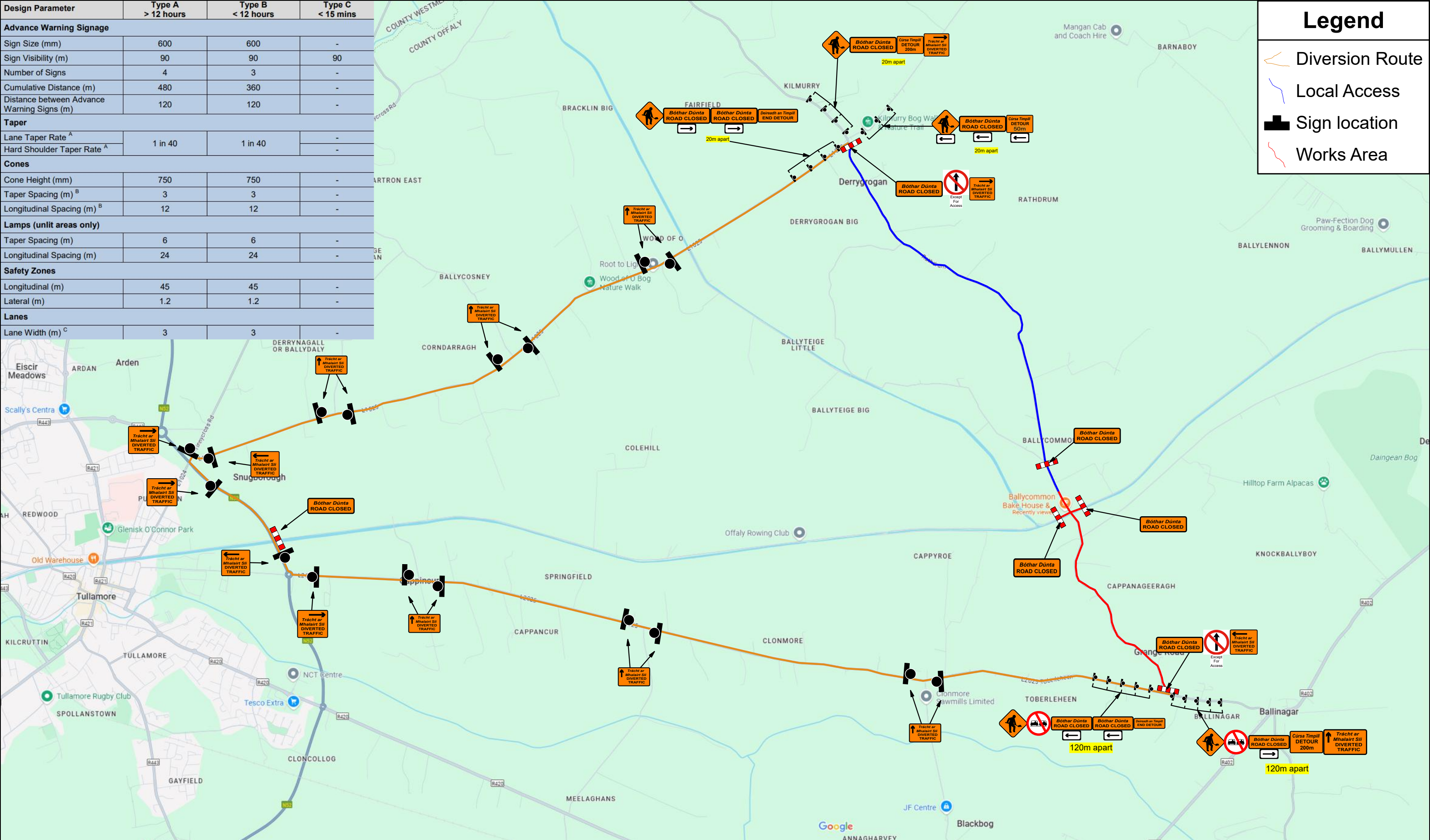

Legend

Diversion Route

Local Access

Sign location

Works Area

Bealach Isteach  
SITE ACCESS

Dromchla  
Neamhchriochnaithe  
UNFINISHED ROAD SURFACE

P085

Níl Aon Marcanna Bóthar  
NO ROAD MARKINGS

P011A

Job Details: Resurfacing

Drawing: Road Closure

Title: Edenderry, Offaly.

Client:

Drawn by: Sevastian Beslic

Scale: N.T.S

Drawing No: 01

GENERAL NOTES:

1) ALL INFORMATION CONTAINED IN THIS DRAWING SHOULD BE CHECKED AND VERIFIED BY CONTRACTOR PRIOR TO ANY STAGE OF CONSTRUCTION.

2) ALL WORKS ARE TO BE CARRIED OUT IN ACCORDANCE WITH LOCAL AUTHORITY REQUIREMENTS AND ARE TO BE INCLUDED IN THE SITE-SPECIFIC SAFETY/HEALTH PLAN.

3) SITE INSPECTION AND MAINTENANCE OFF THE TRAFFIC MANAGEMENT LAYOUT IS TO BE AGREED WITH LOCAL AUTHORITY TO ENSURE THE SAFETY AND INTEGRITY OF THE DESING.

4) CONTRACTOR TO CARRY OUT A SITE RISK ASSESSMENT PRIOR TO THE INSTALLATION OFF ANY TRAFFIC MANAGEMENT PLAN TO ENSURE THAT CONDITION REFLECT THOSE CONSIDERED FOR DESING POST SUMISSION.

5) CONTRACTOR SHALL BE RESPONSIBLE FOR THE PROVISION OFF RAMP(S) ACCESS AT ANY CHANGE IN ROAD SURFACE LEVEL WHERE TRAFFIC RUNS ON A TEMPORARY SURFACE, AND FOR PEDESTRIAN/CYCLE RAMP(S) WHERE FOOTPATH/CYCLE-WAYS HAVE A LEVEL DISCONTINUITIV AS PER RESULT OF THE WORKS.

6) THIS TRAFFIC MANAGEMENT PLAN MAY ONLY BE IMPLEMENTED BY A (TTOS) WHO MUST CARRY OUT A RISK ASSESSMENT BEFORE IMPLEMENTATION. (TTOS) MUST BE IN POSSESSION OF (CSCS) CARD (SIGNING, LIGHTNING AND GUARDING AT ROAD WORKS) CONSTRUCTION REGULATION 2006.

SITE SPECIFIC NOTES:

(RUNNING LANE WIDTH) 3.0m MINIMUM

(ALL WORKS) TO BE CARRIED OUT IN ACCORDANCE WITH LOCAL AUTHORITY. CONTRACTOR TO AGREE SYSTEM OF WORKS SO THAT SAFETY ZONES AND MINIMUM LANE WIDTH MAY BE PROVIDED AND MAINTAINED AT ALL THE TIMES. (TTOS) TO PROVIDE (WORKS ACCES) AND (LATERAL SAFETY ZONE) SUPERVISION.

EXACT SINGS POSITION TO BE AGREED ON SITE.

PRIVATE ACCESS TO BE MAINTAINED AT ALL TIME

PEDESTRIAN TO BE PROTECTED FROM WORKS AREA BY PEDESTRIAN BARRIER SYSTEM.

PEDESTRIAN RAMP TO BE PROVIDE WHERE NECESSARY FOR DISABLED PEOPLE AND CHILDREN PRAM ACCESS.

OVERHEAD CABLES SIGN (WK) TO BE USED IF OVERHEAD CABLES BECOME A HAZARD DUE TO WORK LOCATION.

Client:

LAKELAND CIVIL ENGINEERING

www.lakelandcivil.ie

Rev:

Date: 2.04.2025

SDS

TRAFFIC MANAGEMENT SERVICES